

Read this instruction carefully. See hardware and furniture part list for guidance. Be sure all parts are complete, before you assemble. Place all wooden furniture parts on a clean and flat soft surface to prevent from being scratched. Follow the figure to start assembling.

CAUTIONS : 1. Do not FULLY - TIGHTEN the nut or nut bolt until all nut or bolt is ready assembled.
2. Do not OVER - TIGHTEN the nut or bolt to avoid causing damages to the thread.
3. Keep all hardware parts out of reach of children.

NOTE : THE LIST AND QUANTITY SHOWN ARE FOR 1 UNIT ASSEMBLY.

Tool needed : Screwdriver & Rubber Mallet (not provider).

PART LIST		
ITEM	DESCRIPTION	QTY
A	NIGHTSTAND	1 PC
B	LEG	4 PCS
C	LEG SUPPORT FRONT	1 PC
D	LEG SUPPORT BACK	1 PC
E	LEG SUPPORT L/R	2 PCS

PART LIST		
ITEM	DESCRIPTION	QTY
1	JCBC BOLT M6 x 50mm	4 PCS
2	JCBC BOLT M6 x 70mm	4 PCS
3	M6 SPRING WASHER	8 PCS
4	WOOD SCREW M4 x 30mm	6 PCS
5	WOOD DOWEL M8 x 30mm	5 PCS
6	M4 ALLEN KEY (BALL SHAPE)	1 PC
7	CONNECTOR SCREW FASTENERS	4 PCS

STEP 1

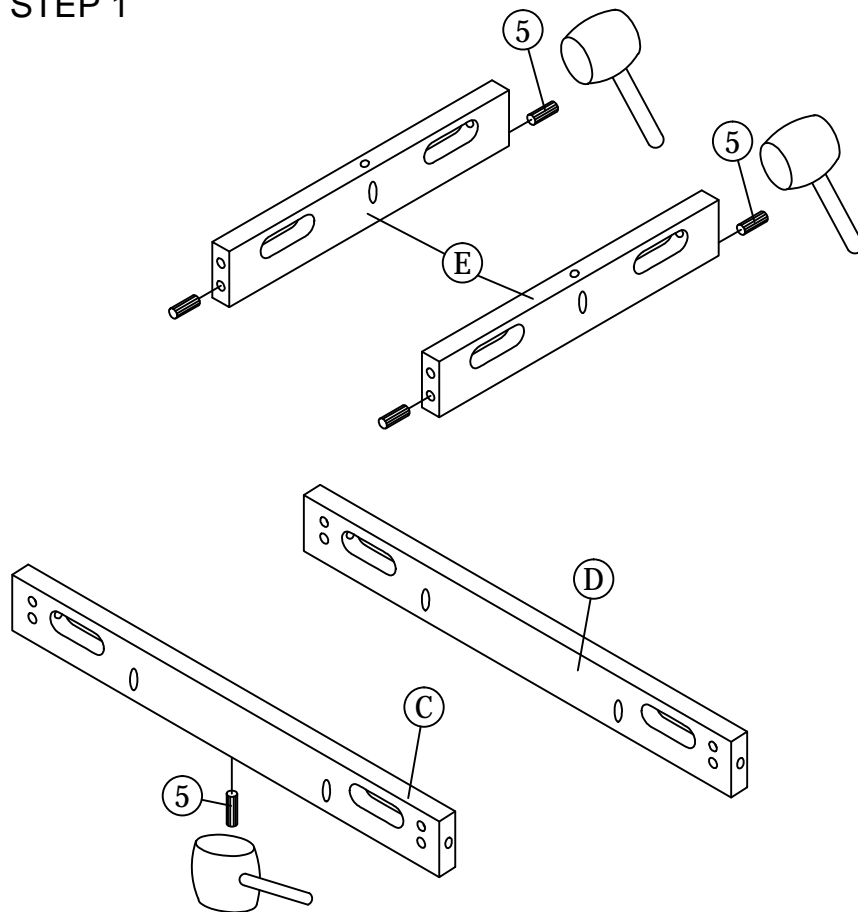

STEP 2

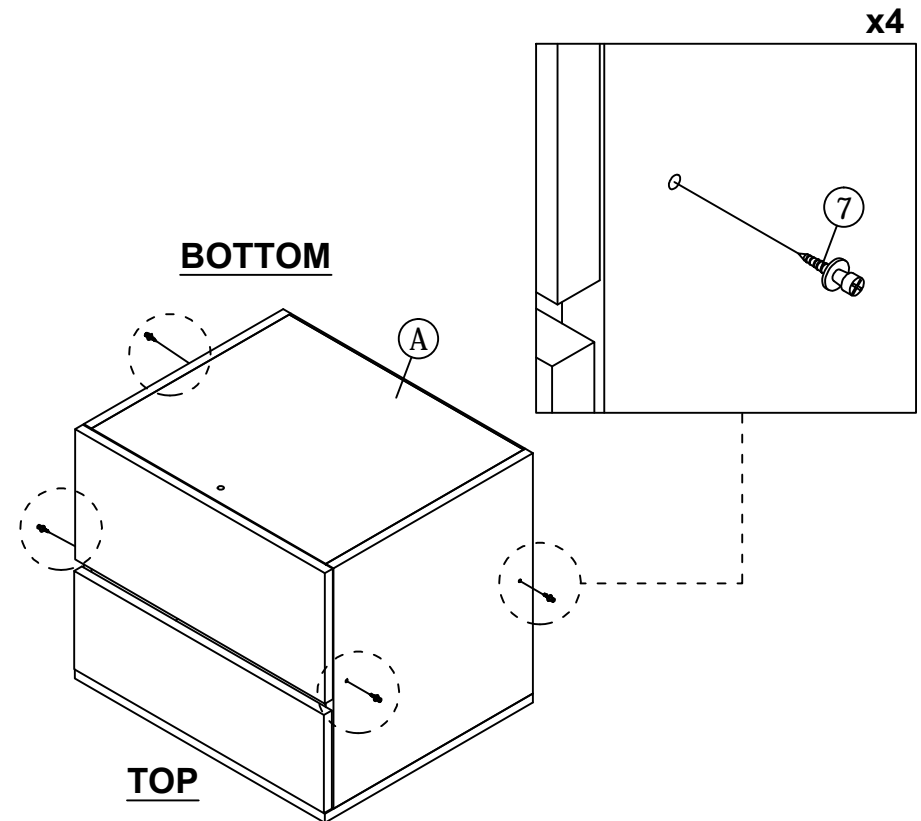

ASSEMBLY INSTRUCTIONS

2 OF 4

STEP 3

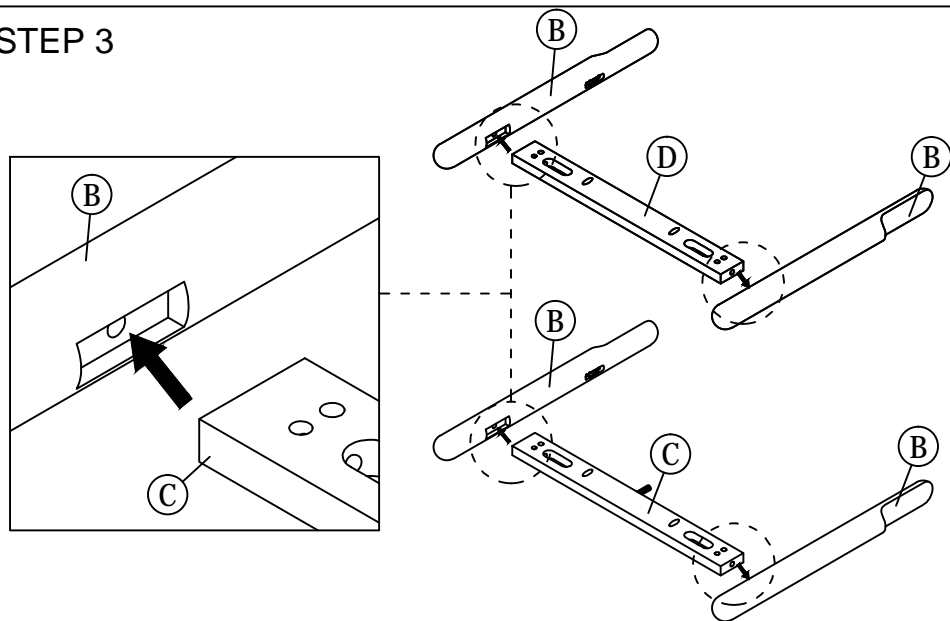

STEP 4

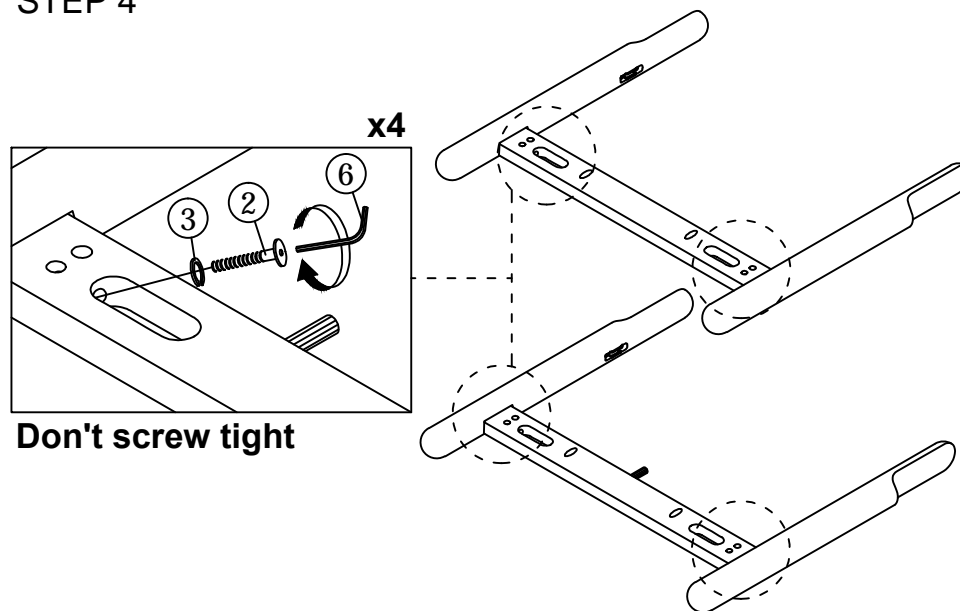

STEP 5

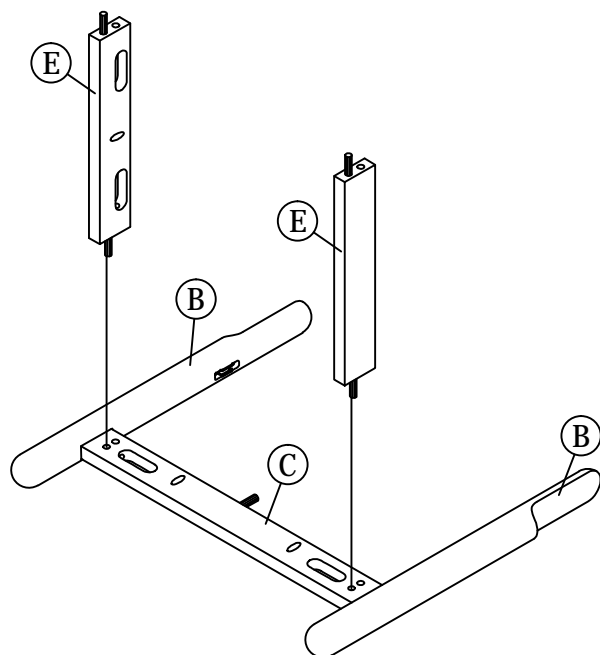

STEP 6

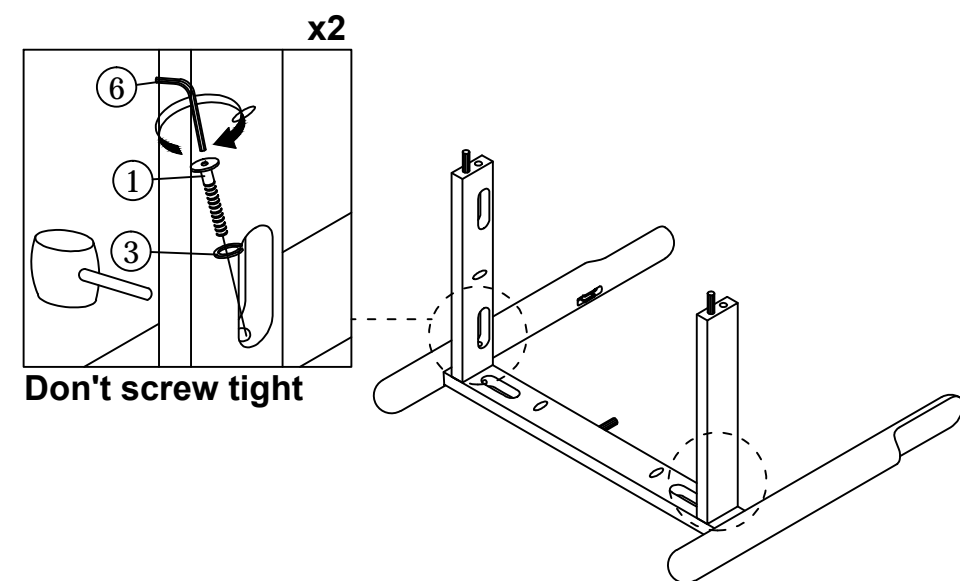

ASSEMBLY INSTRUCTIONS

3 OF 4

STEP 7

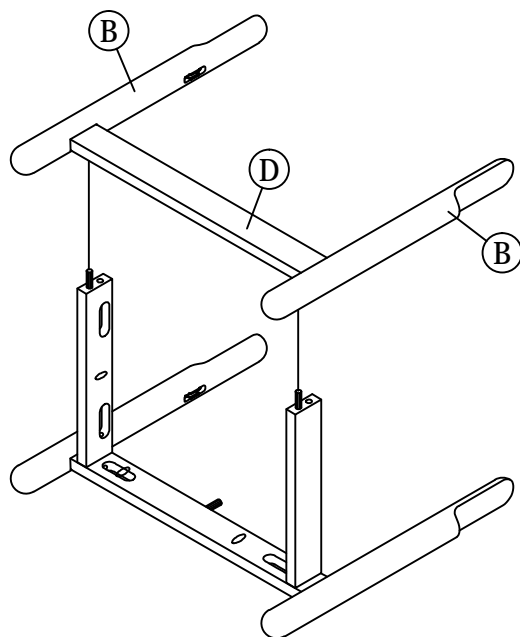

STEP 8

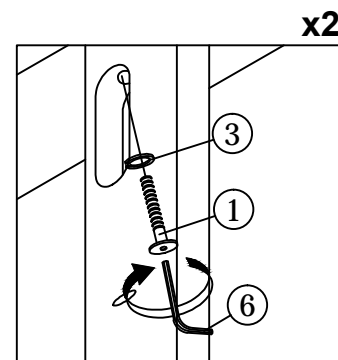

Don't screw tight

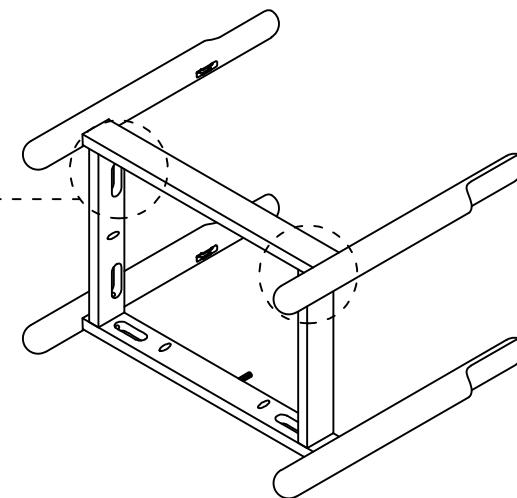

STEP 9

Finish step 9, Please screw tight the step 4 , 6 & 8 bolts.

BOTTOM

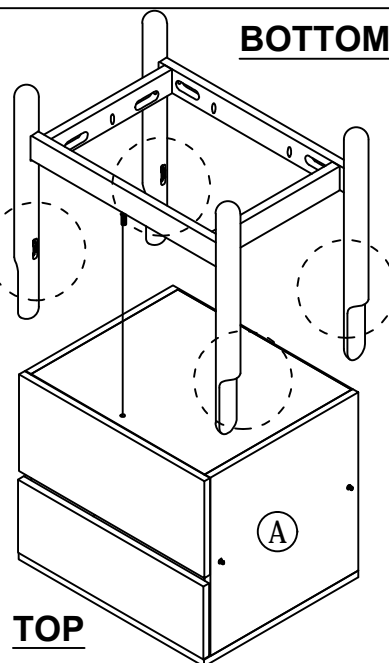
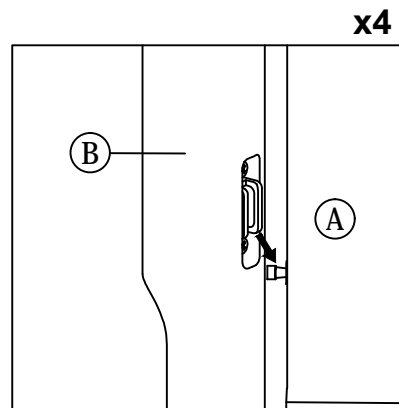

TOP

STEP 10

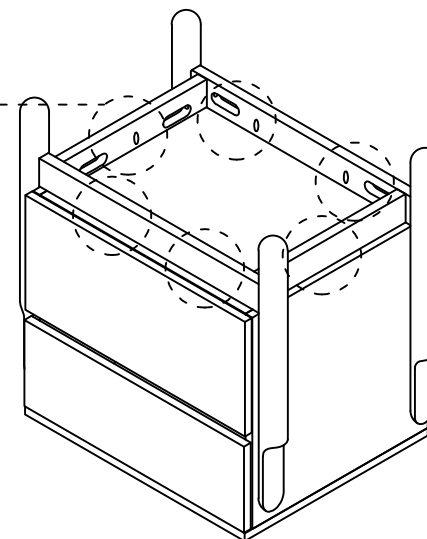
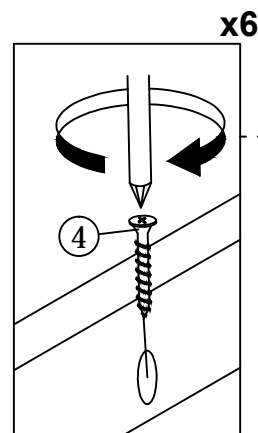

ASSEMBLY INSTRUCTIONS

4 OF 4

STEP 11

